

Code 29631LR-G

Total Chlorine 

25 Test Strips

Insta-Test® ANALYTIC

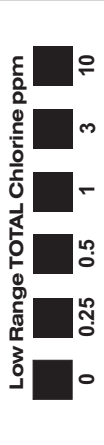

Using a cup-size sample, dip strip for **2 seconds**. **Remove strip vertically**, as shown. **DO NOT SHAKE OFF EXCESS WATER**. With pad still vertical, wait **10 seconds** and **read** the strip. Discard strip after 30 seconds.

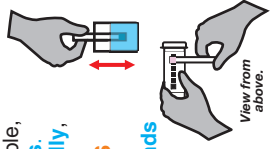

View from above.

- Keep wet fingers out of the bottle.
- Cap bottle tightly after removing strip.
- Store in a cool, dry place.



LaMotte Company
802 Washington Ave., Chestertown, MD 21620 USA
410-778-3100 • www.lamotte.com



Drop holding box and dotted tolerance line